



300 Old Pretoria Road Albany, GA 31721
Phone: 229-883-1440 Fax: 229-317-8225
www.thrushaircraft.com

CUSTOM KIT

CK-AG-52

REV A: 06/18/2024

INSTALLATION OF C352TS FIRE EXTINGUISHER

AIRCRAFT AFFECTED:

MODEL

S2R

SERIAL NUMBERS

ALL

A handwritten signature in black ink, appearing to read "David E. Yarbrough", written over a horizontal line.

David Yarbrough

Director of Engineering



300 Old Pretoria Road Albany, GA 31721
Phone: 229-883-1440 Fax: 229-317-8225
www.thrushaircraft.com

LOG OF REVISIONS

NOTE: Reformatting and correction of typographical errors is not considered revision.

REV	PAGE	DESCRIPTION OF REVISION	BY
IR	All	New Document Initial Release	T. Vicks 09/28/2020
A	All	Updated to right hand installation for Dual Cockpit aircraft.	T. Surratt 06/18/2024



TABLE OF CONTENTS

1. PURPOSE/REASON FOR PUBLICATION.....	4
2. SCOPE/COMPLIANCE.....	4
3. BY WHOM WORK WILL BE ACCOMPLISHED.....	4
4. APPROVAL.....	4
5. MAN HOURS.....	4
6. SPECIAL TOOLS.....	4
7. PARTS LIST.....	5
8. INSTALLATION INSTRUCTIONS.....	6
9. RECORD OF COMPLIANCE.....	12
10. RESPONSE CARD.....	12
11. CUSTOM KIT CK-AG-52 REV A COMPLIANCE REPORT.....	13



1. PURPOSE/REASON FOR PUBLICATION

This Custom Kit is to give instructions for the installation of the fire extinguisher on the right-hand side of the cockpit.

2. SCOPE/COMPLIANCE

This Custom Kit is intended for the installation of the fire extinguisher within the cockpit on the right-hand side of all S2R Dual Cockpit aircraft at the owner/operator's discretion.

3. BY WHOM WORK WILL BE ACCOMPLISHED

The work is to be accomplished by an FAA Certified A&P, IA mechanic, or foreign equivalent.

4. APPROVAL

4.1 THRUSH AIRCRAFT, LLC

This Custom Kit is approved by the Engineering Department at Thrush Aircraft, LLC.

4.2 FAA APPROVAL

The technical content of this Custom Kit is FAA approved.

5. MAN HOURS

This Custom Kit may take approximately 1 hour to accomplish.

6. SPECIAL TOOLS

None



7. PARTS LIST

Quantity	Part Number	Description
1	MS27039-1-09	SCREW
1	MS21044N3	NUT
1	NAS1149F0363P	WASHER
1	MS21919WDG16	CLAMP
1	262020002-001	BRACKET
1	MS21314-12	STRAP, RETAINING
3	MS27039-4-09	SCREW
3	NAS1149F0463P	WASHER
3	MS21044N4	NUT
1	C352TS	FIRE EXTINGUISHER
1	10852-1	PLACARD

8. INSTALLATION INSTRUCTIONS

1. Remove the contents of the fire extinguisher kit box.
2. Step up the top, left holes and the bottom, center holes in the red mount and the white bracket to .25-inch.
3. Locate the red fire extinguisher mount (red mount) to the white bracket (262020002-001) in the proper position as shown in Figure 8-1.

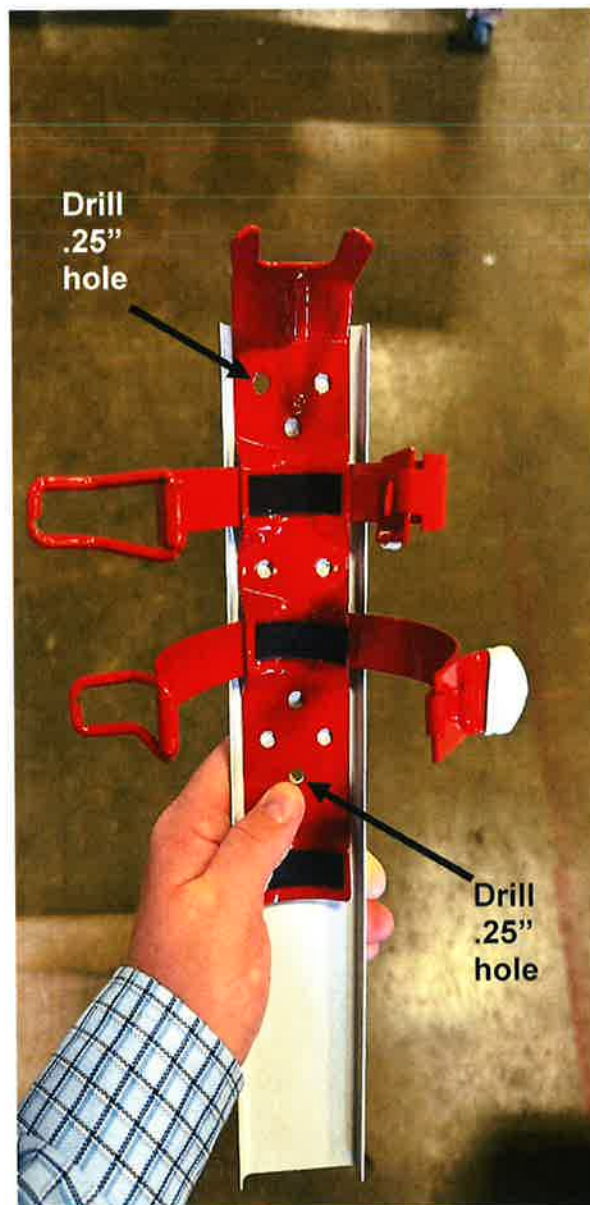

Figure 8-1

4. Hold the parts together by temporarily installing the appropriate hardware in the aligned holes of the red mount and the white bracket. (Reference Figure 8-2)

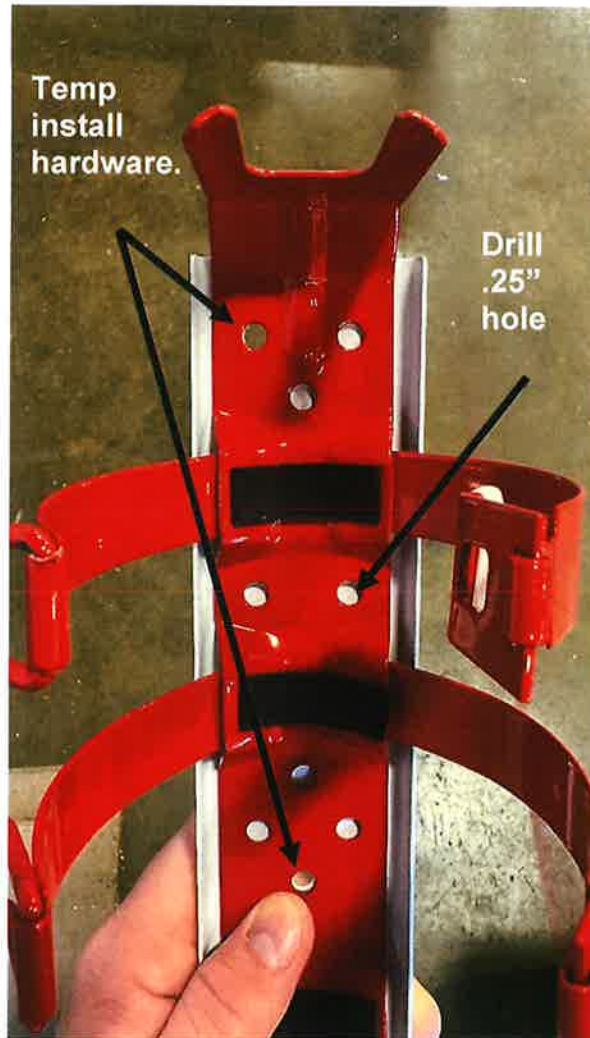

Figure 8-2

5. Match-drill a .25-inch hole through the white bracket as shown in Figure 8-2.
6. Separate the parts then deburr.
7. Reposition the red mount to the white bracket as done prior. (Reference Figure 8-1)

8. Install the appropriate hardware in the hole that only attaches the red mount to the white bracket. (Reference Figure 8-3)

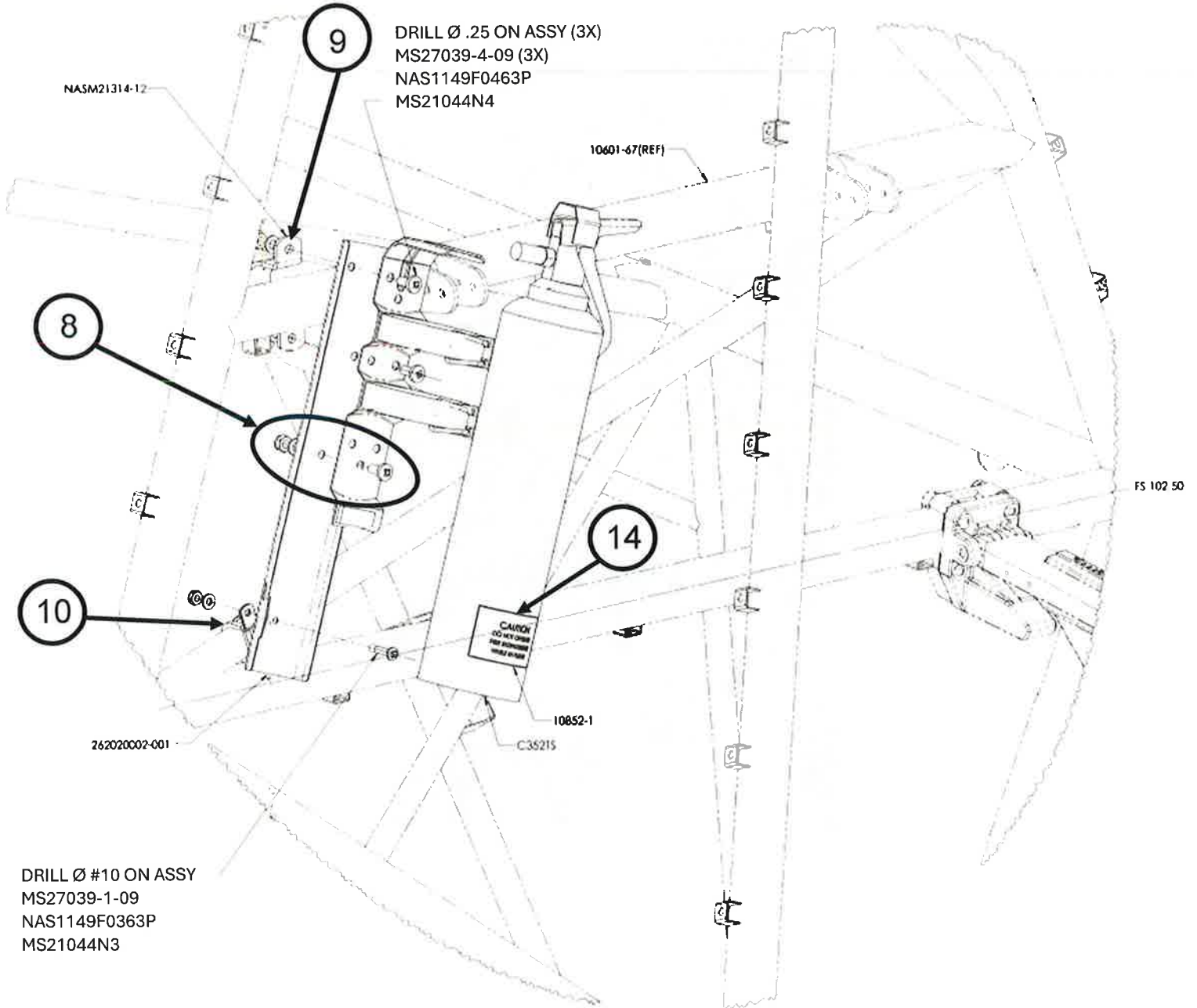

Figure 8-3

9. Inside the cockpit, locate the retaining strap (MS21314-12) on the horizontal fuselage tube and install the bracket/mount assembly using the appropriate hardware as shown in Figure 8-4. (Also reference Figure 8-3)

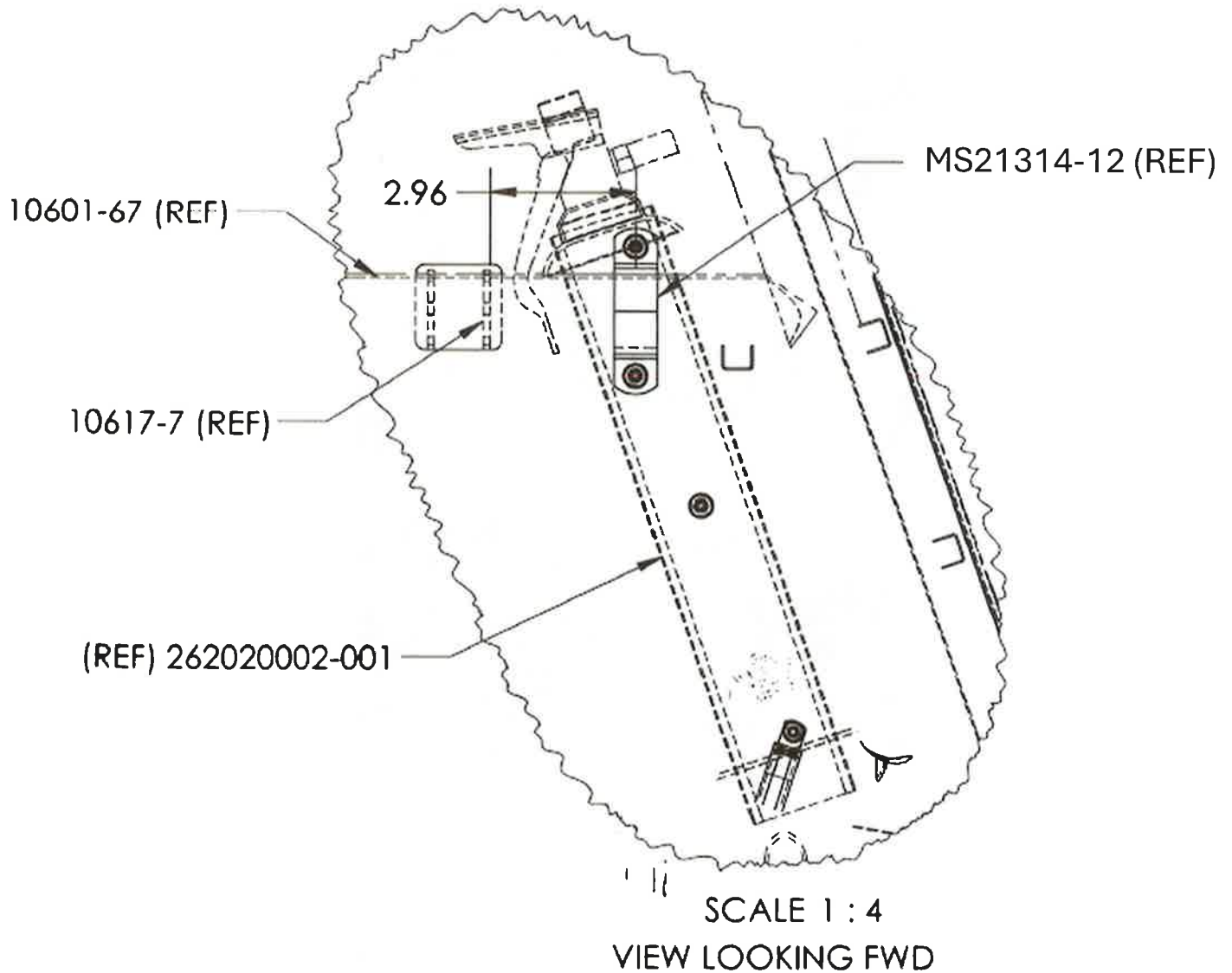

Figure 8-4

10. Locate the clamp (MS21919WDG16) on the diagonal fuselage tube, as far to the right as possible as shown in Figure 8-5. (Also reference Figure 8-3)



Figure 8-5

11. Match-drill a #10 hole through the clamp, into the white bracket.
12. Deburr the hole.
13. Install the white bracket to the clamp using the appropriate hardware as shown in Figure 8-3. (Also reference Figure 8-5)

14. Install the black and white CAUTION placard (10852-1) on the fire extinguisher as shown in Figure 8-3. (Also reference Figure 8-6)
15. Mount the fire extinguisher (C352TS) to the red mount then fasten the straps to hold the fire extinguisher securely in place as shown in Figure 8-6.



Figure 8-6

16. Ensure to remove all FOD from the cockpit.



9. RECORD OF COMPLIANCE

Make appropriate entry in airplane maintenance records as follows:
"Thrush Custom Kit CK-AG-52 Rev A complied with at _____ total hours on
aircraft."

Modification accomplished by:

Name & Certificate #	Date
----------------------	------

10. RESPONSE CARD

The final step in compliance with this Custom Kit is to complete and return the compliance card on the next page. It may be mailed, faxed, or scanned and e-mailed.

Fax:	Thrush Support	229-317-8225
Email:	Thrush Support	support@thrushaircraft.com



11. CUSTOM KIT CK-AG-52 REV A COMPLIANCE REPORT

Aircraft S/N:	Aircraft Owner:
Aircraft Registration #:	Address of Owner:
CK-AG-58 REV:	
Airframe Total Time:	City & State:
Engine Total Time:	Physical Location:
Complied With By:	Date of Compliance:
Signature:	Certificate #:

PLEASE RETURN THIS REPORT ONLY AFTER MODIFICATION IS MADE
This response card may be mailed, faxed to (229) 317-8225, or emailed to support@thrushaircraft.com.

Fold, Tape, & Mail (Do Not Staple)

Return Address:

Thrush Aircraft LLC.
Attn: Customer Assurance and Support
300 Old Pretoria Road
Albany, GA 31721

